

Catalyst Cortisol Test

Quick Reference Guide

Storage and handling requirements

- + Store in the freezer (do not store in the freezer door).
- + No warming required—run directly from the freezer.
- + Catalyst™ Cortisol tests can be stored at room temperature for up to 8 hours. After 8 hours, tests can be returned to the freezer up to 5 times, as long as the foil pouch is unopened.
- + Sample volume required:
 - Whole blood: 0.7 cc (700 µL)
 - Serum/plasma: 100 µL (65 µL minimum; 300 µL if running with other slides)

Just load and go!

Catalyst One™ Chemistry Analyzer

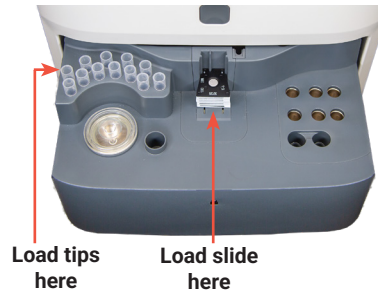

Catalyst Dx™ Chemistry Analyzer

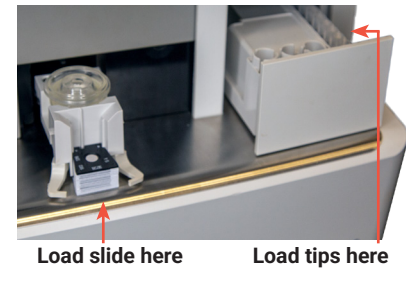

Frequently asked questions

Question	Answer						
How do I run Catalyst Cortisol on my Catalyst analyzer?	<p>For the Catalyst One analyzer:</p> <ul style="list-style-type: none"> + For the initial cortisol test: Initiate the run on the IDEXX VetLab™ Station. On the Select Instruments screen, tap Catalyst One and then tap Cortisol. Select the desired protocol and its additional protocol steps, tap Save, and then tap Run. + For additional tests/multistep cortisol testing: All the protocol steps selected when the initial test was processed appear in the In Process list on the IDEXX VetLab Station Home screen. When it's time to process the next sample, tap the next available test in the list, tap Queued, and then tap Start Run. <p>For the Catalyst Dx analyzer:</p> <ul style="list-style-type: none"> + For the initial cortisol test: Initiate the run as you normally would on the IDEXX VetLab Station. At the end of the run, identify the protocol and protocol step when prompted and then tap Submit. Note: If you choose to enter the protocol/protocol step later, tap the patient in the In Process list, tap Add Details, and then select the patient's protocol information. + For additional tests/multistep cortisol testing: <ol style="list-style-type: none"> 1. Locate the patient's initial cortisol result on the IDEXX VetLab Station OR select the applicable patient from the Pending list on the Home screen. 2. Tap Add Test and then tap Append Results. 3. On the Select Instruments screen, select Catalyst Dx. 4. When prompted at the end of the run, select the run's protocol information and then tap Submit. 						
Will I receive interpretive comments with the results?	Yes! Once you have selected the appropriate protocol and all steps are completed, interpretive comments are provided with the final result.						
Can Catalyst Cortisol be run with other slides?	Yes! The test can be run alone or with other slides as part of a comprehensive patient profile. For example, you could run a Catalyst™ Lyte 4 CLIP, any other Catalyst chemistry CLIP, and a Catalyst™ Cortisol Test with one patient sample.						
When running with other slides, should Catalyst Cortisol be loaded in a particular order?	<ul style="list-style-type: none"> + The Catalyst Cortisol slide can be loaded in any order after electrolytes. + When running the Catalyst Cortisol test with electrolyte slides, always load the electrolyte slides first. + For the quickest time to results, the recommended load order is Lyte 4 CLIP on the bottom, followed by any other chemistry CLIP, the Catalyst Cortisol slide, any additional slides, and TT4 on top. 						
Which species have been validated for Catalyst Cortisol and what are the numerical results?	<table border="1"> <thead> <tr> <th>Species</th> <th>U.S. units</th> <th>S.I./French units</th> </tr> </thead> <tbody> <tr> <td>Canine</td> <td>0.5–30.0 µg/dL</td> <td>14–828 nmol/L</td> </tr> </tbody> </table>	Species	U.S. units	S.I./French units	Canine	0.5–30.0 µg/dL	14–828 nmol/L
Species	U.S. units	S.I./French units					
Canine	0.5–30.0 µg/dL	14–828 nmol/L					
What is the run time for Catalyst Cortisol?	Catalyst Cortisol results are available ~13 minutes after the start of the run.						
Is it okay to dilute samples that are undergoing cortisol testing?	IDEXX does not support the use of diluted samples when running Catalyst Cortisol.						