

# Catalyst\* Pancreatic Lipase (PL) Test

## Quick Reference Guide

### Storage and handling requirements

- Store in the freezer (do not store in the freezer door).
- No warming required—run directly from the freezer.
- Pancreatic Lipase tests can be stored at room temperature for up to 8 hours. After 8 hours, store tests in the freezer.
- Recommended sample volume:
  - Whole blood: 600–800 µL
  - Serum/plasma: 100 µL (65 µL minimum; 300 µL if running with other slides)

### Just load and go!

Catalyst One\* Chemistry Analyzer

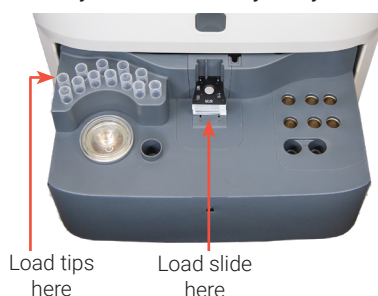

Catalyst Dx\* Chemistry Analyzer

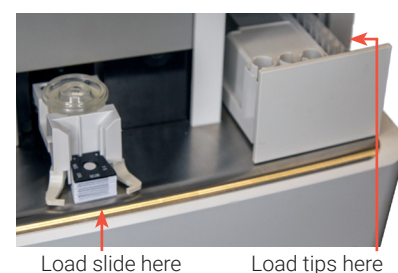

### Frequently asked questions

Question	Answer
What sample types can be run on the Pancreatic Lipase test?	Compatible sample types include serum, lithium heparin plasma, and whole blood using the Catalyst* Lithium Heparin Whole Blood Separator.
Which species have been validated for the Pancreatic Lipase test and what are the numerical results?	Canine and feline species are supported with the Pancreatic Lipase test. Numerical results of 30–2,000 U/L for canine species and 0.5–50.0 U/L for feline species will be reported.
Can the Pancreatic Lipase test be run with other slides?	Yes! The test can be run alone or with other slides as part of a comprehensive patient profile. For example, you could run a Catalyst* Lyte 4 CLIP, a Catalyst* Chem 17 CLIP, a Catalyst* SDMA Test, and a Catalyst* Pancreatic Lipase Test with one patient sample.
When running with other slides, should the Pancreatic Lipase test be loaded in a particular order?	<ul style="list-style-type: none"> <li>• The Pancreatic Lipase slide can be loaded in any order after electrolytes.</li> <li>• When running the Pancreatic Lipase test with electrolyte slides, <b>always</b> load the electrolyte slides first.</li> <li>• For the <b>quickest</b> time to results, the recommended load order is Lyte 4 CLIP on the bottom, followed by a chemistry CLIP (e.g., Chem 17, Chem 15), the Pancreatic Lipase slide, any additional slides, and TT<sub>4</sub> on top.</li> <li>• Be sure to load the drawer with pipette tips before every run. (The maximum number of slides per run is 25 slides.)</li> </ul>
What is the run time for the Pancreatic Lipase test?	Pancreatic Lipase results are available ~9 minutes after the start of the run.
Is it okay to dilute samples that are undergoing Pancreatic Lipase testing?	IDEXX does not support the use of diluted samples when running the Pancreatic Lipase test.
How often can Pancreatic Lipase tests be left at room temperature and then returned to the freezer?	Once at room temperature, Pancreatic Lipase tests can be returned to the freezer up to 5 times as long as they are unopened.
What if a Pancreatic Lipase test is accidentally refrigerated?	Any test suspected of having been stored in the refrigerator should be discarded.
Which quality control should I use to monitor the performance of the Pancreatic Lipase test?	VetTrol* Control is designed for use in monitoring the accuracy of the Catalyst Dx and Catalyst One analyzers. IDEXX also recommends monthly analyzer maintenance to ensure the accuracy of these analyzers.